

APPROXIMATE WEIGHT:  
1,013 LBS (0.25 CY)

DESIGN NOTES:

1. CONCRETE TO BE 5,000 PSI @ 28 DAYS
2. REINFORCING TO BE GRADE 60, BLACK

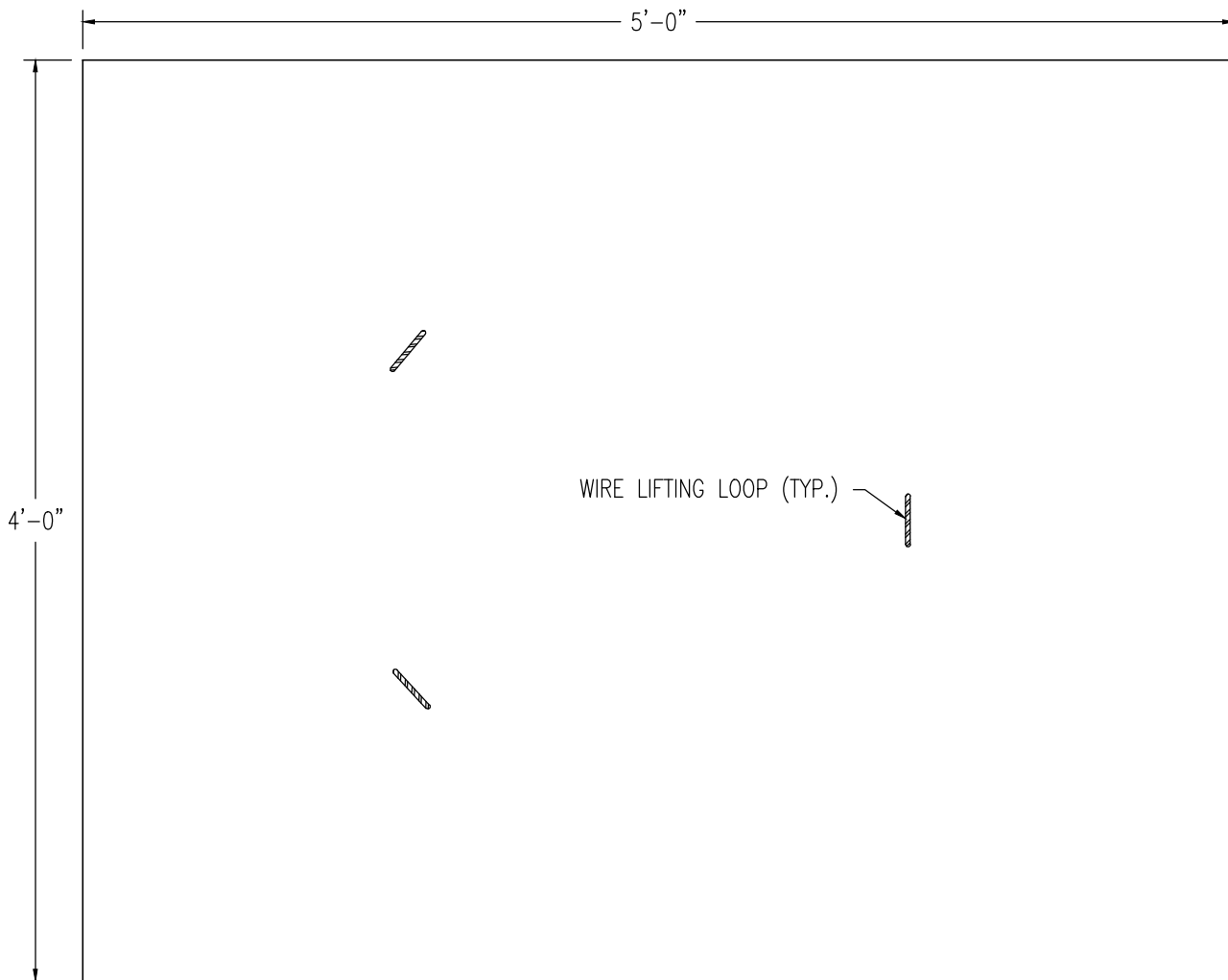

TOP VIEW

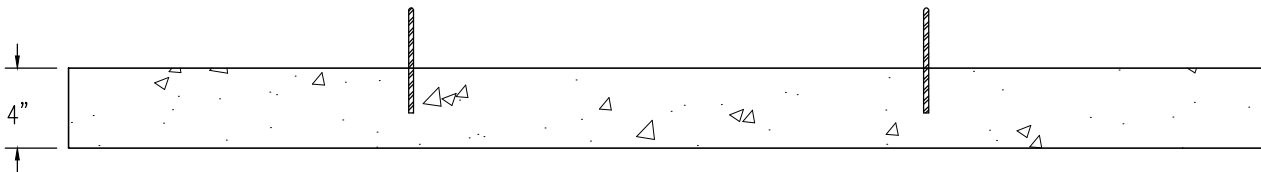

SECTION VIEW

PRODUCT: 4'X5' OIL TANK SLAB

ITEM NUMBER: SLOILTANKH

SCALE: 1-1/4" = 1'-0"

DRAWN BY: KJN

DATE: 7/02/24



**PRECAST  
OF MAINE**

139 MAIN STREET, PO BOX 307

TOPSHAM, ME 04086

(207) 729-1628

WWW.PRECASTOFMAINE.COM